

CONTENTES

ANSI Valves

■ CLASS 150 Globe Valves (Bolted Bonnet) OS & Y	Cast Bronze	API 600	3
■ CLASS 150 Swing Check Valves (Bolted Bonnet)	Cast Bronze	API 600	4
■ CLASS 150 Gate Valves (Bolted Bonnet) OS & Y	Cast Bronze	API 600	5
■ CLASS 150 Globe Valves (Bolted Bonnet) OS & Y	Nickel Aluminum Bronze	API 600	6
■ CLASS 150 Swing Check Valves (Bolted Bonnet)	Nickel Aluminum Bronze	API 600	7
■ CLASS 150 Gate Valves (Bolted Bonnet) OS & Y	Nickel Aluminum Bronze	API 600	8
■ CLASS 150 Globe Valves (Bolted Bonnet) OS & Y	Stainless Steel	API 600	9
■ CLASS 150 Swing Check Valves (Bolted Bonnet)	Stainless Steel	API 600	10
■ CLASS 150 Gate Valves (Bolted Bonnet) OS & Y	Stainless Steel	API 600	11
■ CLASS 150 Gate Valves (Bolted Bonnet) OS & Y Gear Box Type	Cast Bronze	API 600	12
■ Class 150 Hydrant Valves 30°	Cast Bronze	JYV Hydrant	13
■ Class 150 Hydrant Valves	Cast Bronze	Ref DIN86211	14
■ ASTM B62 Gate Valves (Screw Bonnet)Non Rising Stem	Cast Bronze	MSS-SP-80	15
■ ASTM B62 Globe Valves (Screw Bonnet)	Cast Bronze	MSS-SP-80	16
■ ASTM B62 Globe Screw-Down Check Valves (Screw Bonnet)	Cast Bronze	MSS-SP-80	16
■ CLASS 300 Globe Valves (Union Bonnet)	Cast Bronze	Ref JIS F7348	17
■ CLASS 300 Globe Screw-Down Check Valves (Union Bonnet)	Cast Bronze	Ref JIS F7413	17
■ CLASS 150 Globe Valves (Union Bonnet)	Cast Bronze	Ref JIS F7348	18
■ CLASS 150 Globe Screw-Down Check Valves (Union Bonnet)	Cast Bronze	Ref JIS F7413	18
■ CLASS 150 Gate Valves (Union Bonnet)	Cast Bronze	Ref JIS F7368	19
■ CLASS 300 Gate Valves (Union Bonnet)	Cast Bronze	Ref JIS F7368	20
■ CLASS 150 Swing Check Valves (Screw Bonnet)	Cast Bronze	Ref JIS F7371	21
■ CLASS 150 Swing Check Valves (Bolted Bonnet)	Cast Bronze	Ref JIS F7373	21
■ CLASS 150 Lift Check Valves (Union Bonnet)	Cast Bronze	Ref JIS F7417	22
■ CLASS 150 Lift Check Valves (Bolted Bonnet)	Cast Bronze	Ref JIS F7358	22
■ CLASS 150 Gate Valves (Bolted Bonnet) Non Rising Stem	Cast Bronze	Ref JIS F7364	23



ANSI VALVE AMERICAN NATIONAL STANDARD INSTITUTE

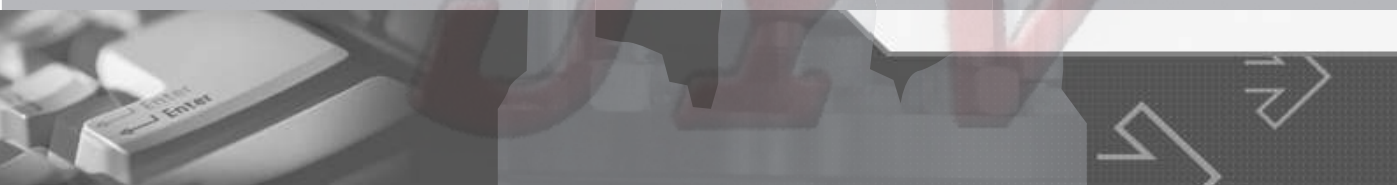

Cast Bronze ANSI Valves

■ CLASS 150 Globe Valves (Bolted Bonnet) OS&Y

API 600

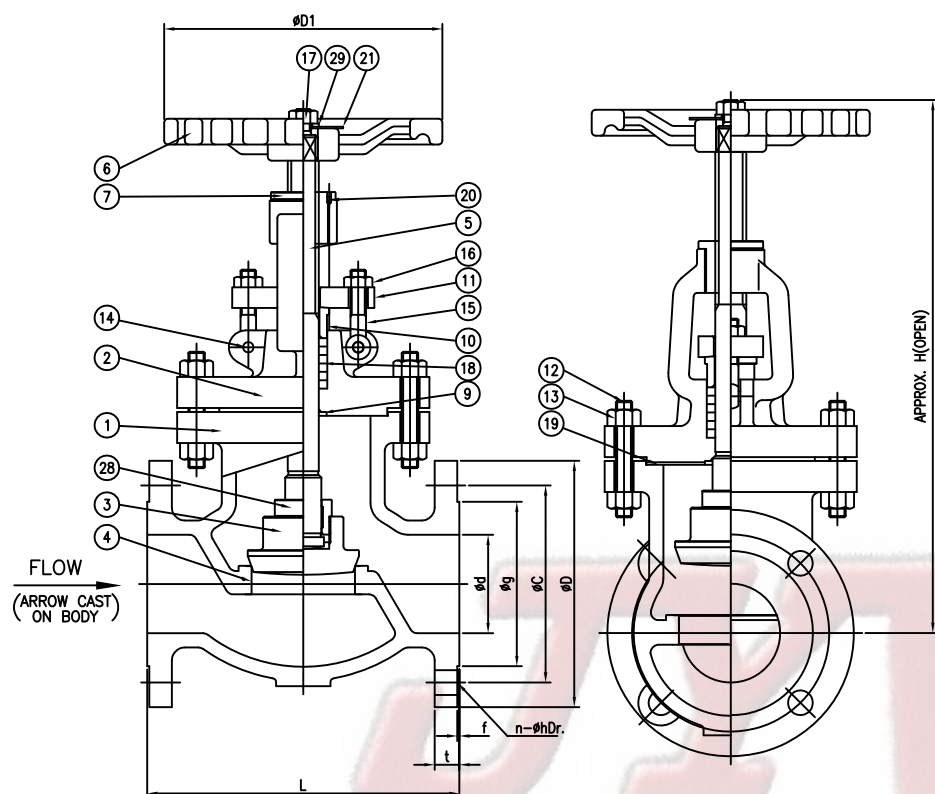

Bolted Bonnet Intergral seat
Rising Stem Flanged Ends

NO.	PARTS	MATERIAL
1	BODY	BRONZE / ASTM B62
2	BONNET	BRONZE / ASTM B62
3	DISC	BRONZE / ASTM B62
4	SEAT	INTERGRAL
5	STEM	BRASS / ASTM B124
6	HANDWHEEL	CAST IRON / ASTM B126
7	YORK SLEEVE	BRASS
9	BACK SEAT	INTERGRAL
10	GRLAND BUSH	INTERGRAL
11	GRAND PLATE	BRONZE
12	BONNET BOLT	STAINLESS STEEL
13	BONNET NUT	STAINLESS STEEL
14	EYE BOLT PIN	BRASS / A276-304
15	EYE BOLT	STAINLESS STEEL
16	EYE BOLT NUT	STAINLESS STEEL
17	WHEEL NUT	STAINLESS STEEL
18	GRAND PACKING	NON ASBESTOS
19	GASKET	NON ASBESTOS
20	SET SCREW	STAINLESS STEEL
21	NAME PLATE	ALUMNUM
28	DISC GRAND	BRASS
29	WASHER	STEEL

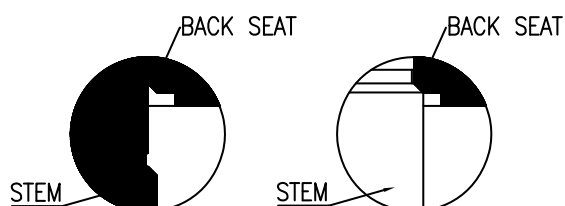

Test Pressure (Psi)

Rating	ANSI 150#
Size	2" to 16"
Hydrostatic press test (Shell)	450
Hydrostatic press test (Seat)	325

1. HYDRO TEST : API598
2. FACE TO FACE : ANSI B16.10
3. FLANGE : ANSI B16.5
4. "f" dimension : 1.6mm

Dimension Table (Unit : mm)

Rating	Size	2"	2 1/2"	3"	4"	5"	6"	8"	10"	12"	14"	16"
ANSI 150#	d	50	65	80	100	125	150	200	250	300	335	380
	D	152	178	191	229	254	279	343	406	483	533	597
	C	120.7	139.7	152.4	190.5	215.9	241.3	298.5	362	431.8	476.3	539.8
	g	91.9	104.6	127	157.2	185.7	215.9	269.7	323.9	381	412.8	469.9
	t	15.8	17.6	19.1	23.9	23.9	25.4	28.5	30.3	31.8	35.1	36.6
	N-øh	4-19	4-19	4-19	8-19	8-23	8-23	8-23	12-26	12-26	12-29	16-29
	L	203.2	215.9	241.3	292.1	355.6	406.4	495.3	622.3	698.5	787.0	914.4
	H	275	290	320	350	400	440	560	670	740	1050	1590

Remark : 1. The name plate shall be specified by purchaser as required.

✖ It's prohibited to copy or transcribe arbitrarily.



Cast Bronze ANSI Valves

CLASS 150 Swing Check Valves (Bolted Bonnet)

API 600

Bolted Bonnet Integral seat

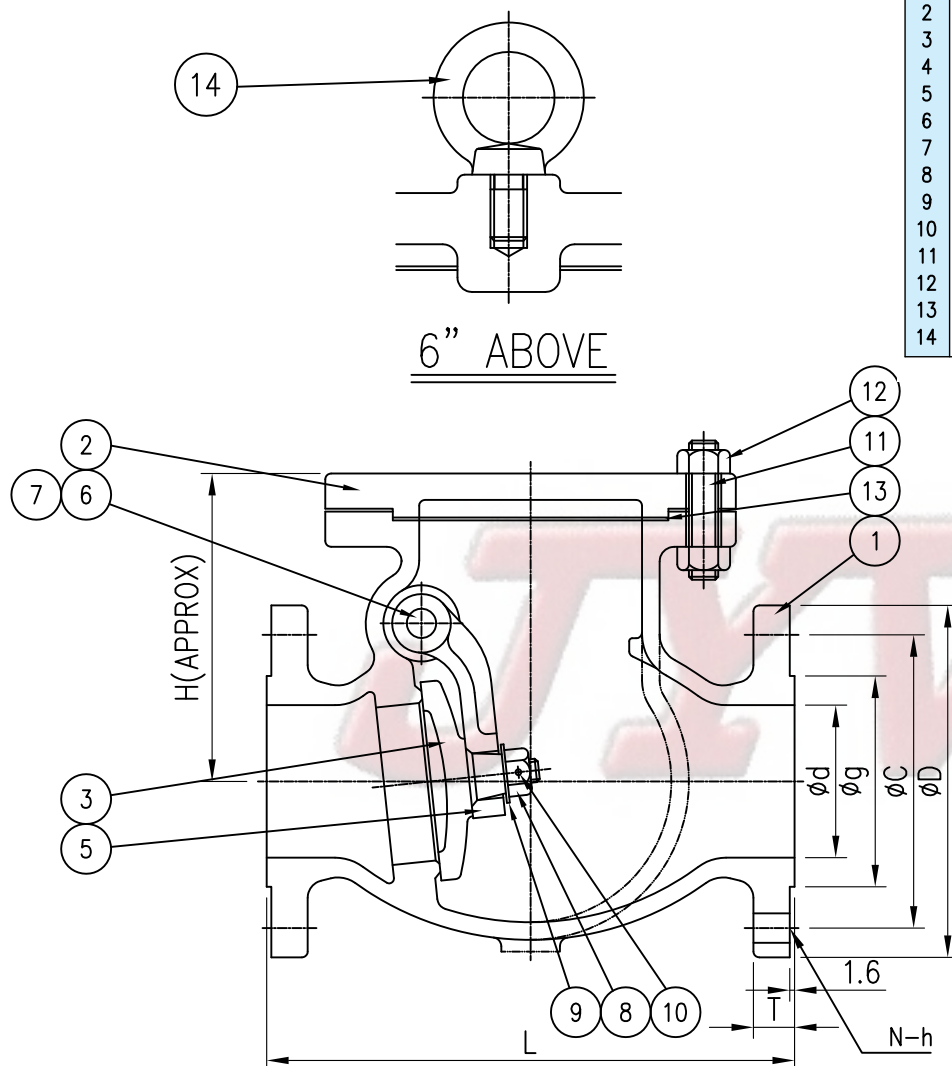

NO.	PARTS	MATERIAL
1	BODY	BRONZE / ASTM B62
2	BONNET	BRONZE / ASTM B62
3	DISC	BRONZE / ASTM B62
4	SEAT	INTERGRAL
5	ARM	BRONZE / ASTM B62
6	HINGE PIN	STAINLESS STEEL
7	PLUG	BRASS /STAINLESS STEEL
8	DISC LOCK NUT	BRASS
9	WASHER	STAINLESS STEEL
10	SPLIT PIN	BRONZE
11	BONNET BOLT	STAINLESS STEEL
12	BONNET NUT	STAINLESS STEEL
13	GASKET	NON ASBESTOS
14	EYE BOLT	STAINLESS STEEL

Test Pressure (Psi)

Rating	ANSI 150#
Size	2" to 16"
Hydrostatic press test (Shell)	450
Hydrostatic press test (Seat)	325

1. HYDRO TEST : API598
2. FACE TO FACE : ANSI B16.10
3. FLANGE : ANSI B16.5

Dimension Table

(Unit : mm)

Rating	Size	2"	2 1/2"	3"	4"	5"	6"	8"	10"	12"	14"	16"
ANSI 150#	d	50	65	80	100	125	150	200	250	300	335	380
	D	152	178	191	229	254	279	343	406	483	533	597
	C	120.7	139.7	152.4	190.5	215.9	241.3	298.5	362	431.8	476.3	539.8
	g	91.9	104.6	127	157.2	185.7	215.9	269.7	323.9	381	412.8	469.9
	t	15.8	17.6	19.1	23.9	23.9	25.4	28.5	30.3	31.8	35.1	36.6
	N-øh	4-19	4-19	4-19	8-19	8-23	8-23	8-23	12-26	12-26	12-29	16-29
	L	203.2	215.9	241.3	292.1	330.2	355.6	495.3	622.3	698.5	787.0	864
	H	115	129	137	161	188	206	247	368	450	459	526

Remark : 1. The name plate shall be specified by purchaser as required.

✖ It's prohibited to copy or transcribe arbitrarily.

Cast Bronze ANSI Valves

■ CLASS 150 Gate Valves (Bolted Bonnet) OS & Y

API 600

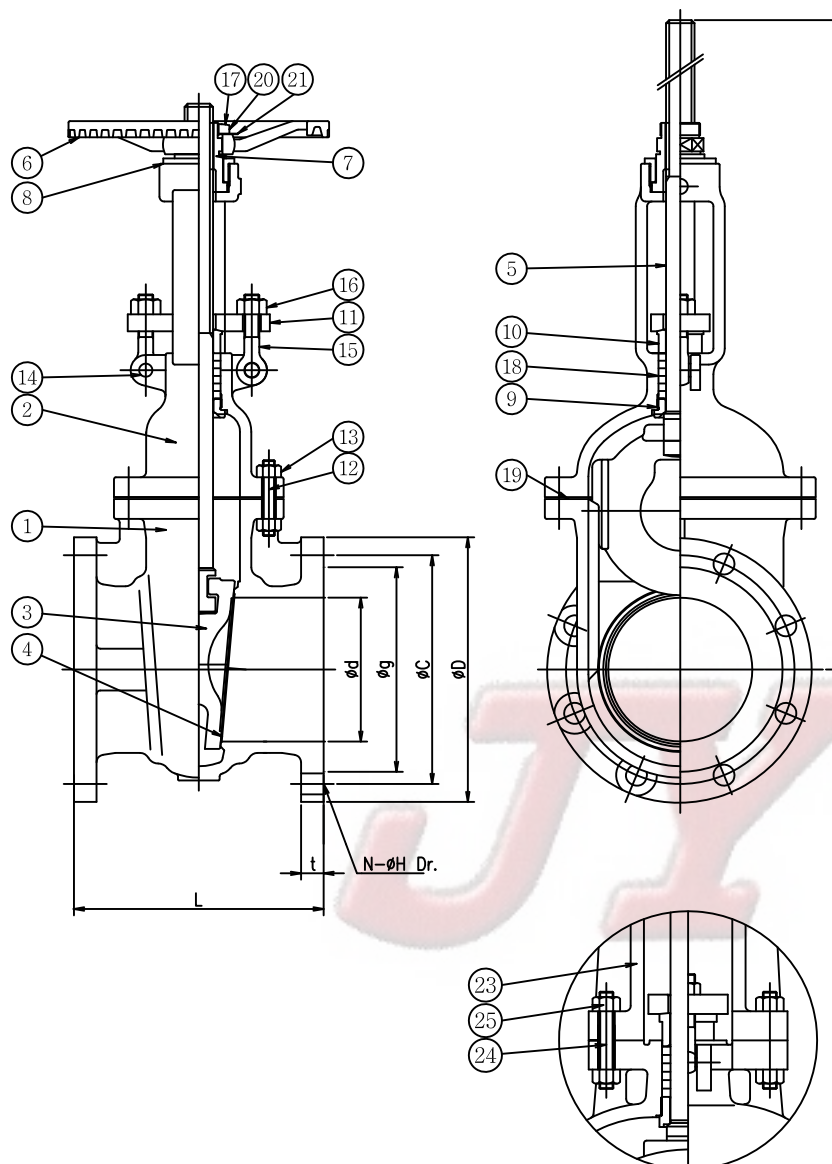

Bolted Bonnet Flexible seat
Rising Stem Flanged Ends

NO.	PARTS	MATERIAL
1	BODY	BRONZE / ASTM B62
2	BONNET	BRONZE / ASTM B62
3	DISC (FLEXIBLE)	BRONZE / ASTM B62
4	SEAT	INTERGRAL
5	STEM	BRASS / ASTM B124
6	HANDWHEEL	CAST IRON / ASTM B126
7	YORK SLEEVE	BRASS
8	SLEEVE GRAND	BRASS
9	GUIDE BUSH	INTEGRAL
10	GRAND BUSH	INTEGRAL
11	PACKING GLAND	BRONZE
12	BONNET BOLT	STAINLESS STEEL
13	BONNET NUT	STAINLESS STEEL
14	EYE BOLT PIN	BRASS / A276-304
15	EYE BOLT	STAINLESS STEEL
16	EYE BOLT NUT	STAINLESS STEEL
17	WHEEL NUT	BRASS
18	GRAND PACKING	NON ASBESTOS
19	GASKET	NON ASBESTOS
20	SET SCREW	STAINLESS STEEL
21	NAME PLATE	ALUMNUM
23	YORK	BRONZE / ASTM B62
24	YORK BOLT	STAINLESS STEEL
25	YORK BOLT NUT	STAINLESS STEEL

SEPARATE YOKE TYPE
8" AND OVER

Test Pressure (Psi)

Rating	ANSI 150#
Size	2" to 16"
Hydrostatic press test (Shell)	450
Hydrostatic press test (Seat)	325

1. HYDRO TEST : API598
2. FACE TO FACE : ANSI B16.10
3. FLANGE : ANSI B16.5

Dimension Table

(Unit : mm)

Rating	Size	2"	2 1/2"	3"	4"	5"	6"	8"	10"	12"	14"	16"
ANSI 150#	d	50	65	80	100	125	150	200	250	300	335	380
	D	152	178	191	229	254	279	343	406	483	533	597
	C	120.7	139.7	152.4	190.5	215.9	241.3	298.5	362	431.8	476.3	539.8
	g	91.9	104.6	127	157.2	185.7	215.9	269.7	323.9	381	412.8	469.9
	t	15.8	17.6	19.1	23.9	23.9	25.4	28.5	30.3	31.8	35.1	36.6
	N- ϕ h	4-19	4-19	4-19	8-19	8-23	8-23	8-23	12-26	12-26	12-29	16-29
	L	177.8	190.5	203.2	228.6	254.0	266.7	292.1	330.2	355.6	381.0	406.4
	H	356	415	468	565	647	762	1065	1285	1480	1523	1740

Remark : 1. The name plate shall be specified by purchaser as required.

✖ It's prohibited to copy or transcribe arbitrarily.

Cast Nickel Aluminum Bronze ANSI Valves

■ CLASS 150 Globe Valves (Bolted Bonnet) OS & Y

API 600

Bolted Bonnet Integral seat
Rising Stem Flanged Ends

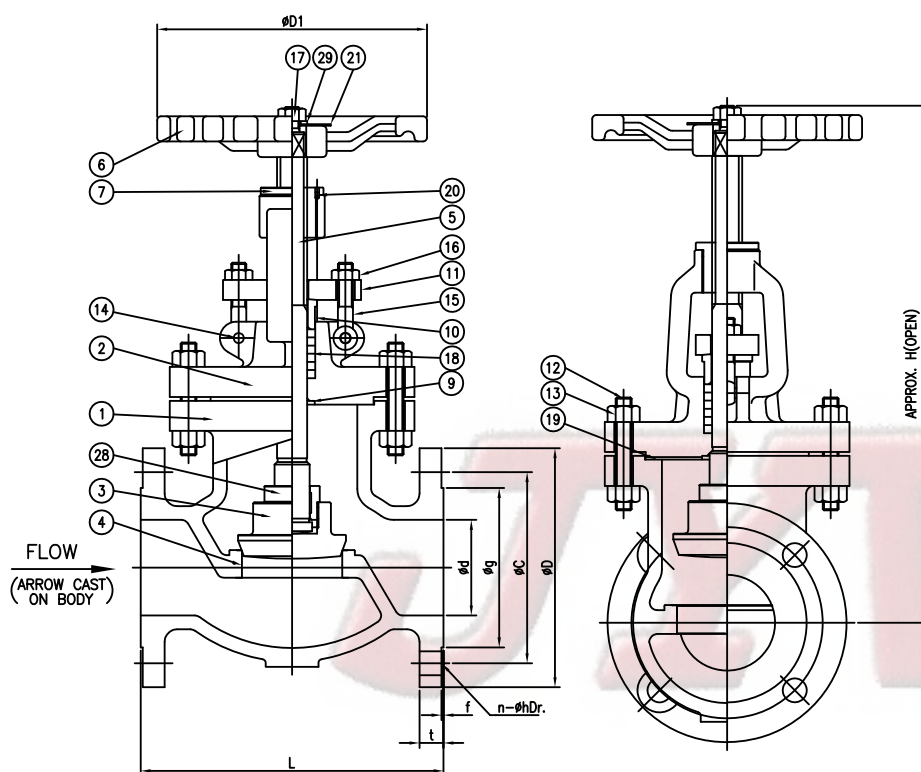

NO.	PARTS	MATERIAL
1	BODY	ASTM B148-C95800
2	BONNET	ASTM B148-C95800
3	DISC	ASTM B148-C95800
4	SEAT	INTERGRAL
5	STEM	ASTM B150-C63000
6	HANDWHEEL	CAST IRON / ASTM B126
7	YORK SLEEVE	BRASS
9	BACK SEAT	INTERGRAL
10	GRLAND BUSH	INTERGRAL
11	GRAND PLATE	BRONZE
12	BONNET BOLT	STAINLESS STEEL
13	BONNET NUT	STAINLESS STEEL
14	EYE BOLT PIN	BRASS / A276-304
15	EYE BOLT	STAINLESS STEEL
16	EYE BOLT NUT	STAINLESS STEEL
17	WHEEL NUT	STAINLESS STEEL
18	GRAND PACKING	NON ASBESTOS
19	GASKET	NON ASBESTOS
20	SET SCREW	STAINLESS STEEL
21	NAME PLATE	ALUMNUM
28	DISC GRAND	ASTM B150-C63000
29	WASHER	STEEL

Test Pressure (Psi)

Rating	ANSI 150#
Size	2" to 16"
Hydrostatic press test (Shell)	450
Hydrostatic press test (Seat)	325

1. HYDRO TEST : API598
2. FACE TO FACE : ANSI B16.10
3. FLANGE : ANSI B16.5
4. " f" dimension : 1.6mm

Dimension Table

(Unit : mm)

Rating	Size	2"	2 1/2"	3"	4"	5"	6"	8"	10"	12"	14"	16"
ANSI 150#	d	50	65	80	100	125	150	200	250	300	335	380
	D	152	178	191	229	254	279	343	406	483	533	597
	C	120.7	139.7	152.4	190.5	215.9	241.3	298.5	362	431.8	476.3	539.8
	g	91.9	104.6	127	157.2	185.7	215.9	269.7	323.9	381	412.8	469.9
	t	15.8	17.6	19.1	23.9	23.9	25.4	28.5	30.3	31.8	35.1	36.6
	N-øh	4-19	4-19	4-19	8-19	8-23	8-23	8-23	12-26	12-26	12-29	16-29
	L	203.2	215.9	241.3	292.1	355.6	406.4	495.3	622.3	698.5	787.0	914.4
	H	275	290	320	350	400	440	560	670	740	1050	1590

Remark : 1. The name plate shall be specified by purchaser as required.

✖ It's prohibited to copy or transcribe arbitrarily.

Cast Nickel Aluminum Bronze ANSI Valves

■ CLASS 150 Swing Check Valves (Bolted Bonnet)

API 600

Bolted Bonnet Integral seat

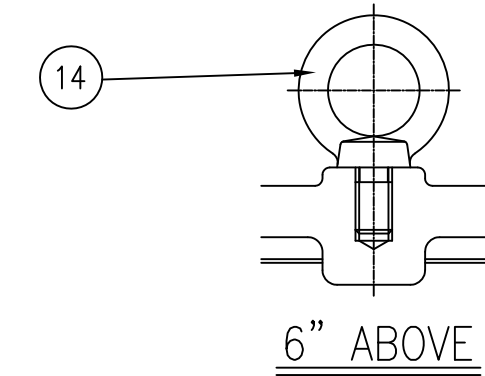

NO.	PARTS	MATERIAL
1	BODY	ASTM B148-C95800
2	BONNET	ASTM B148-C95800
3	DISC	ASTM B148-C95800
4	SEAT	INTERGRAL
5	ARM	ASTM B148-C95800
6	HINGE PIN	STAINLESS STEEL
7	PLUG	BRASS /STAINLESS STEEL
8	DISC LOCK NUT	STAINLESS STEEL
9	WASHER	STAINLESS STEEL
10	SPLIT PIN	STAINLESS STEEL
11	BONNET BOLT	STAINLESS STEEL
12	BONNET NUT	STAINLESS STEEL
13	GASKET	NON ASBESTOS
14	EYE BOLT	STAINLESS STEEL

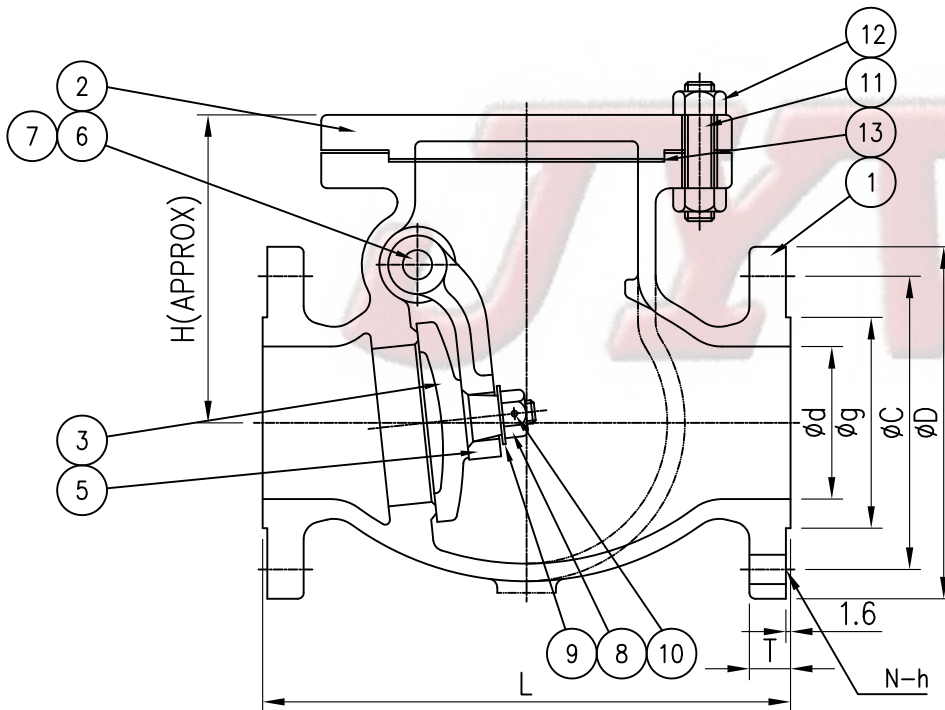

Test Pressure (Psi)

Rating	ANSI 150#
Size	2" to 16"
Hydrostatic press test (Shell)	450
Hydrostatic press test (Seat)	325

1. HYDRO TEST : API598
2. FACE TO FACE : ANSI B16.10
3. FLANGE : ANSI B16.5

Dimension Table

(Unit : mm)

Rating	Size	2"	2 1/2"	3"	4"	5"	6"	8"	10"	12"	14"	16"
ANSI 150#	d	50	65	80	100	125	150	200	250	300	335	380
	D	152	178	191	229	254	279	343	406	483	533	597
	C	120.7	139.7	152.4	190.5	215.9	241.3	298.5	362	431.8	476.3	539.8
	g	91.9	104.6	127	157.2	185.7	215.9	269.7	323.9	381	412.8	469.9
	t	15.8	17.6	19.1	23.9	23.9	25.4	28.5	30.3	31.8	35.1	36.6
	N-øh	4-19	4-19	4-19	8-19	8-23	8-23	8-23	12-26	12-26	12-29	16-29
	L	203.2	215.9	241.3	292.1	330.2	355.6	495.3	622.3	698.5	787.0	864
	H	115	129	137	161	188	206	247	368	450	459	526

Remark : 1. The name plate shall be specified by purchaser as required.

✖ It's prohibited to copy or transcribe arbitrarily.

Cast Nickel Aluminum Bronze ANSI Valves

■ CLASS 150 Gate Valves (Bolted Bonnet) OS & Y

API 600

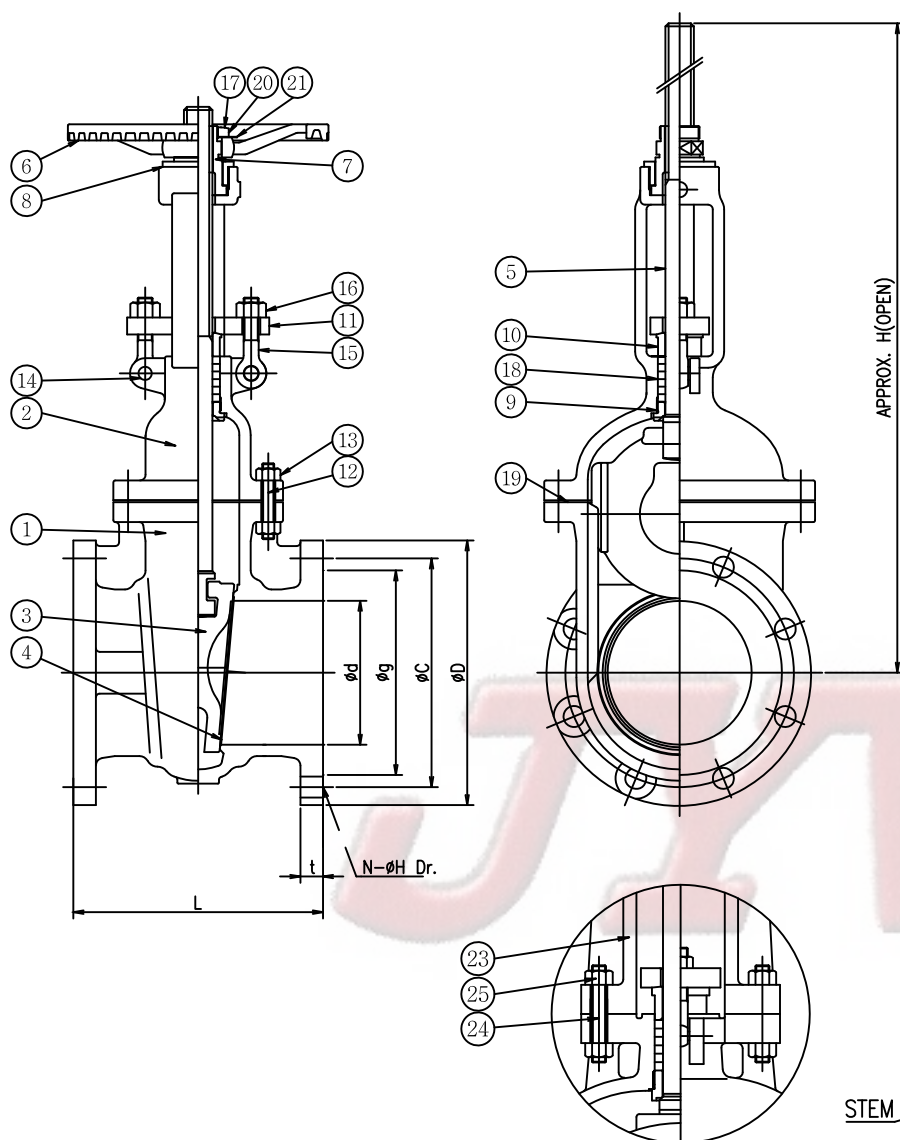

Bolted Bonnet Flexible seat
Rising Stem Flanged Ends

NO.	PARTS	MATERIAL
1	BODY	ASTM B148-C95800
2	BONNET	ASTM B148-C95800
3	DISC (FLEXIBLE)	ASTM B148-C95800
4	SEAT	INTERGRAL
5	STEM	ASTM B150-C63000
6	HANDWHEEL	CAST IRON / ASTM B126
7	YORK SLEEVE	BRASS
8	SLEEVE GRAND	BRASS
9	GUIDE BUSH	INTEGRAL
10	GRAND BUSH	INTEGRAL
11	PACKING GLAND	BRONZE
12	BONNET BOLT	STAINLESS STEEL
13	BONNET NUT	STAINLESS STEEL
14	EYE BOLT PIN	BRASS / A276-304
15	EYE BOLT	STAINLESS STEEL
16	EYE BOLT NUT	STAINLESS STEEL
17	WHEEL NUT	BRASS
18	GRAND PACKING	NON ASBESTOS
19	GASKET	NON ASBESTOS
20	SET SCREW	STAINLESS STEEL
21	NAME PLATE	ALUMNUM
23	YORK	BRONZE / ASTM B62
24	YORK BOLT	STAINLESS STEEL
25	YORK BOLT NUT	STAINLESS STEEL

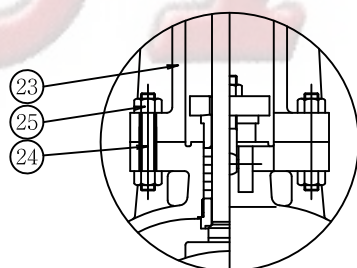

SEPARATE YOKE TYPE
8" AND OVER

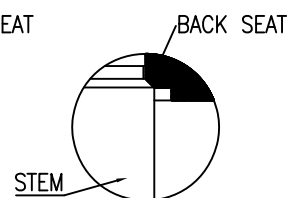
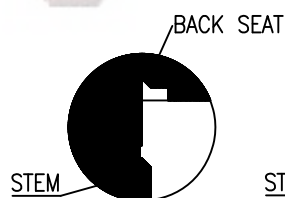

Test Pressure (Psi)

Rating	ANSI 150#
Size	2" to 16"
Hydrostatic press test (Shell)	450
Hydrostatic press test (Seat)	325

1. HYDRO TEST : API598
2. FACE TO FACE : ANSI B16.10
3. FLANGE : ANSI B16.5

Dimension Table

(Unit : mm)

Rating	Size	2"	2 1/2"	3"	4"	5"	6"	8"	10"	12"	14"	16"
ANSI 150#	d	50	65	80	100	125	150	200	250	300	335	380
	D	152	178	191	229	254	279	343	406	483	533	597
	C	120.7	139.7	152.4	190.5	215.9	241.3	298.5	362	431.8	476.3	539.8
	g	91.9	104.6	127	157.2	185.7	215.9	269.7	323.9	381	412.8	469.9
	t	15.8	17.6	19.1	23.9	23.9	25.4	28.5	30.3	31.8	35.1	36.6
	N-øh	4-19	4-19	4-19	8-19	8-23	8-23	8-23	12-26	12-26	12-29	16-29
	L	177.8	190.5	203.2	228.6	254.0	266.7	292.1	330.2	355.6	381.0	406.4
	H	356	415	468	565	647	762	1065	1285	1480	1523	1740

Remark : 1. The name plate shall be specified by purchaser as required.

✖ It's prohibited to copy or transcribe arbitrarily.

Cast Stainless Steel ANSI Valves

■ CLASS 150 Globe Valves (Bolted Bonnet) OS & Y

API 600

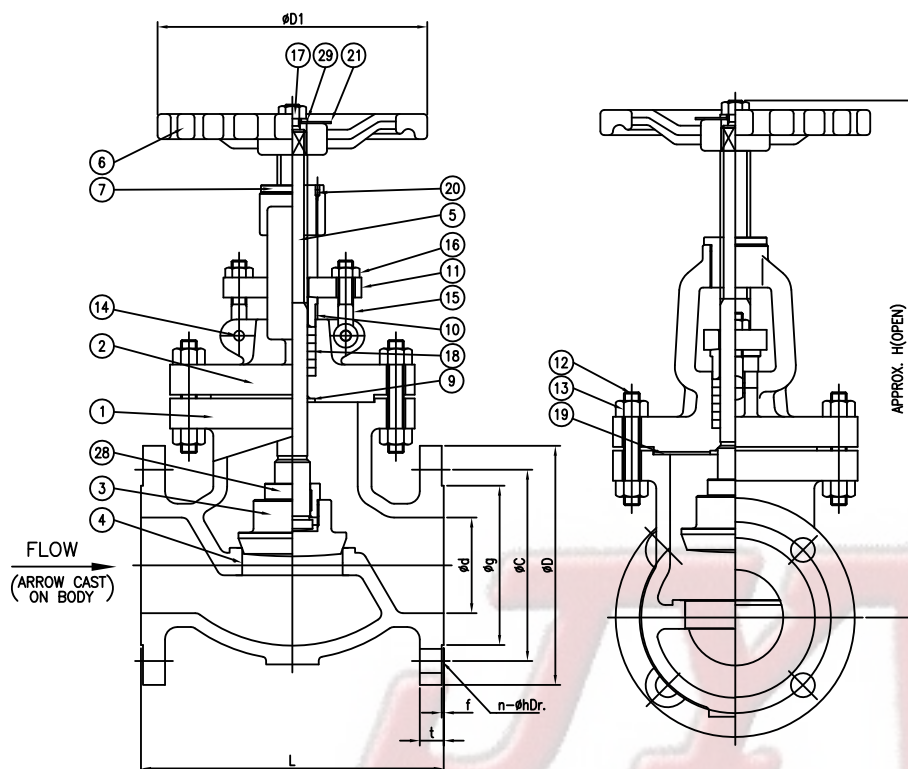

Bolted Bonnet Intergral seat
Rising Stem Flanged Ends

NO.	PARTS	MATERIAL
1	BODY	ASTM A351 Gr. CF8M
2	BONNET	ASTM A351 Gr. CF8M
3	DISC	ASTM A351 Gr. CF8M
4	SEAT	INTERGRAL
5	STEM	ASTM A276 Gr. 316
6	HANDWHEEL	CAST IRON / ASTM B126
7	YORK SLEEVE	BRASS
9	BACK SEAT	INTERGRAL
10	GRLAND BUSH	INTERGRAL
11	GRAND PLATE	STAINLESS STEEL
12	BONNET BOLT	STAINLESS STEEL
13	BONNET NUT	STAINLESS STEEL
14	EYE BOLT PIN	STAINLESS STEEL
15	EYE BOLT	STAINLESS STEEL
16	EYE BOLT NUT	STAINLESS STEEL
17	WHEEL NUT	STAINLESS STEEL
18	GRAND PACKING	NON ASBESTOS
19	GASKET	NON ASBESTOS
20	SET SCREW	STAINLESS STEEL
21	NAME PLATE	ALUMNUM
28	DISC GRAND	BRASS
29	WASHER	STEEL

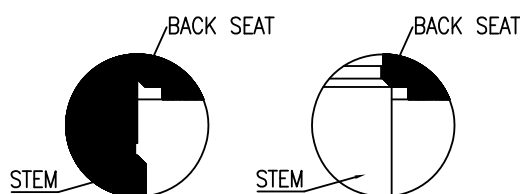

Test Pressure (Psi)

Rating	ANSI 150#
Size	2" to 16"
Hydrostatic press test (Shell)	450
Hydrostatic press test (Seat)	325

1. HYDRO TEST : API598
2. FACE TO FACE : ANSI B16.10
3. FLANGE : ANSI B16.5
4. " f" dimension : 1.6mm

Dimension Table

(Unit : mm)

Rating	Size	2"	2 1/2"	3"	4"	5"	6"	8"	10"	12"	14"	16"
ANSI 150#	d	50	65	80	100	125	150	200	250	300	335	380
	D	152	178	191	229	254	279	343	406	483	533	597
	C	120.7	139.7	152.4	190.5	215.9	241.3	298.5	362	431.8	476.3	539.8
	g	91.9	104.6	127	157.2	185.7	215.9	269.7	323.9	381	412.8	469.9
	t	15.8	17.6	19.1	23.9	23.9	25.4	28.5	30.3	31.8	35.1	36.6
	N-øh	4-19	4-19	4-19	8-19	8-23	8-23	8-23	12-26	12-26	12-29	16-29
	L	203.2	215.9	241.3	292.1	355.6	406.4	495.3	622.3	698.5	787.0	914.4
	H	275	290	320	350	400	440	560	670	740	1050	1590

Remark : 1. The name plate shall be specified by purchaser as required.

✖ It's prohibited to copy or transcribe arbitrarily.



Cast Stainless Steel ANSI Valves

■ CLASS 150 Swing Check Valves (Bolted Bonnet)

API 600

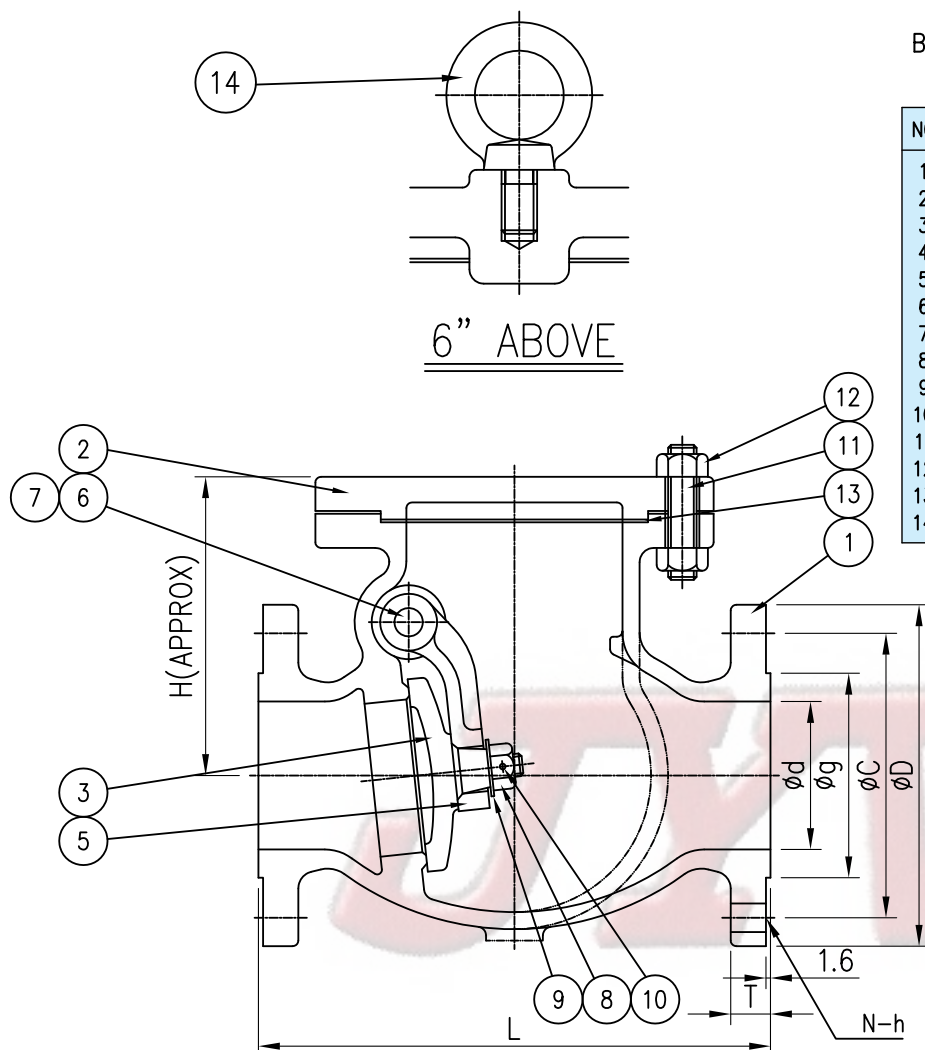

Bolted Bonnet Integral seat

NO.	PARTS	MATERIAL
1	BODY	ASTM A351 Gr. CF8M
2	BONNET	ASTM A351 Gr. CF8M
3	DISC	ASTM A351 Gr. CF8M
4	SEAT	INTERGRAL
5	ARM	ASTM A351 Gr. CF8M
6	HINGE PIN	STAINLESS STEEL
7	PLUG	STAINLESS STEEL
8	DISC LOCK NUT	STAINLESS STEEL
9	WASHER	STAINLESS STEEL
10	SPLIT PIN	STAINLESS STEEL
11	BONNET BOLT	STAINLESS STEEL
12	BONNET NUT	STAINLESS STEEL
13	GASKET	NON ASBESTOS
14	EYE BOLT	STAINLESS STEEL

Test Pressure (Psi)

Rating	ANSI 150#
Size	2" to 16"
Hydrostatic press test (Shell)	450
Hydrostatic press test (Seat)	325

1. HYDRO TEST : API598
2. FACE TO FACE : ANSI B16.10
3. FLANGE : ANSI B16.5

Dimension Table

(Unit : mm)

Rating	Size	2"	2 1/2"	3"	4"	5"	6"	8"	10"	12"	14"	16"
ANSI 150#	d	50	65	80	100	125	150	200	250	300	335	380
	D	152	178	191	229	254	279	343	406	483	533	597
	C	120.7	139.7	152.4	190.5	215.9	241.3	298.5	362	431.8	476.3	539.8
	g	91.9	104.6	127	157.2	185.7	215.9	269.7	323.9	381	412.8	469.9
	t	15.8	17.6	19.1	23.9	23.9	25.4	28.5	30.3	31.8	35.1	36.6
	N-øh	4-19	4-19	4-19	8-19	8-23	8-23	8-23	12-26	12-26	12-29	16-29
	L	203.2	215.9	241.3	292.1	330.2	355.6	495.3	622.3	698.5	787.0	864
	H	115	129	137	161	188	206	247	368	450	459	526

Remark : 1. The name plate shall be specified by purchaser as required.

✖ It's prohibited to copy or transcribe arbitrarily.

Cast Stainless Steel ANSI Valves

■ CLASS 150 Gate Valves (Bolted Bonnet) OS & Y

API 600

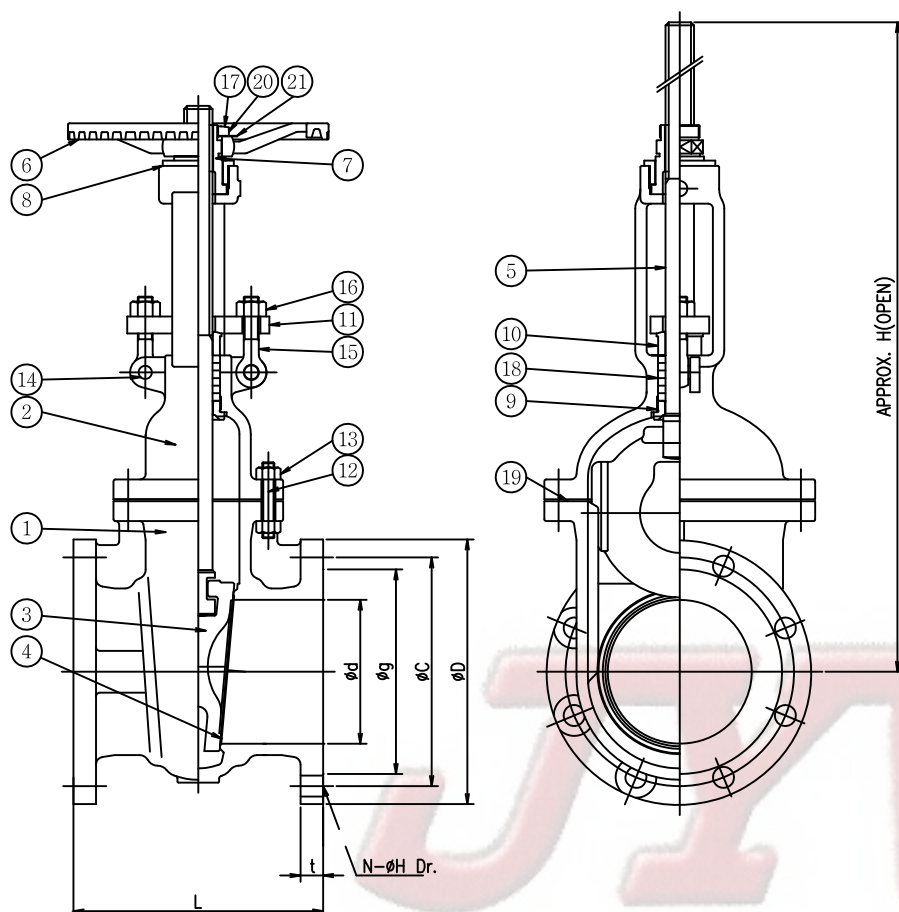

Bolted Bonnet Flexible seat
Rising Stem Flanged Ends

NO.	PARTS	MATERIAL
1	BODY	ASTM A351 Gr. CF8M
2	BONNET	ASTM A351 Gr. CF8M
3	DISC (FLEXIBLE)	ASTM A351 Gr. CF8M
4	SEAT	INTERGRAL
5	STEM	ASTM A276 Gr. 316
6	HANDWHEEL	CAST IRON / ASTM B126
7	YORK SLEEVE	BRASS
8	SLEEVE GRAND	STAINLESS STEEL
9	GUIDE BUSH	INTEGRAL
10	GRAND BUSH	INTEGRAL
11	PACKING GLAND	STAINLESS STEEL
12	BONNET BOLT	STAINLESS STEEL
13	BONNET NUT	STAINLESS STEEL
14	EYE BOLT PIN	BRASS / A276-304
15	EYE BOLT	STAINLESS STEEL
16	EYE BOLT NUT	STAINLESS STEEL
17	WHEEL NUT	BRASS
18	GRAND PACKING	NON ASBESTOS
19	GASKET	NON ASBESTOS
20	SET SCREW	STAINLESS STEEL
21	NAME PLATE	ALUMNUM
23	YORK	ASTM A351 Gr. CF8M
24	YORK BOLT	STAINLESS STEEL
25	YORK BOLT NUT	STAINLESS STEEL

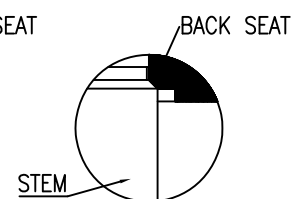
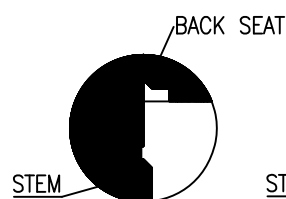
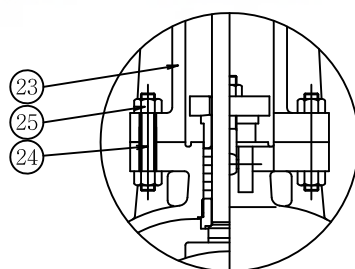

SEPARATE YOKE TYPE
8" AND OVER

Test Pressure (Psi)

Rating	ANSI 150#
Size	2" to 16"
Hydrostatic press test (Shell)	450
Hydrostatic press test (Seat)	325

1. HYDRO TEST : API598
2. FACE TO FACE : ANSI B16.10
3. FLANGE : ANSI B16.5

Dimension Table

(Unit : mm)

Rating	Size	2"	2 1/2"	3"	4"	5"	6"	8"	10"	12"	14"	16"
ANSI 150#	d	50	65	80	100	125	150	200	250	300	335	380
	D	152	178	191	229	254	279	343	406	483	533	597
	C	120.7	139.7	152.4	190.5	215.9	241.3	298.5	362	431.8	476.3	539.8
	g	91.9	104.6	127	157.2	185.7	215.9	269.7	323.9	381	412.8	469.9
	t	15.8	17.6	19.1	23.9	23.9	25.4	28.5	30.3	31.8	35.1	36.6
	N-Øh	4-19	4-19	4-19	8-19	8-23	8-23	8-23	12-26	12-26	12-29	16-29
	L	177.8	190.5	203.2	228.6	254.0	266.7	292.1	330.2	355.6	381.0	406.4
	H	356	415	468	565	647	762	1065	1285	1480	1523	1740

Remark : 1. The name plate shall be specified by purchaser as required.

✖ It's prohibited to copy or transcribe arbitrarily.

Cast Nickel Aluminum Bronze ANSI Valves

■ CLASS 150 Gate Valves (Bolted Bonnet) OS & Y Gear Box Type

API 600

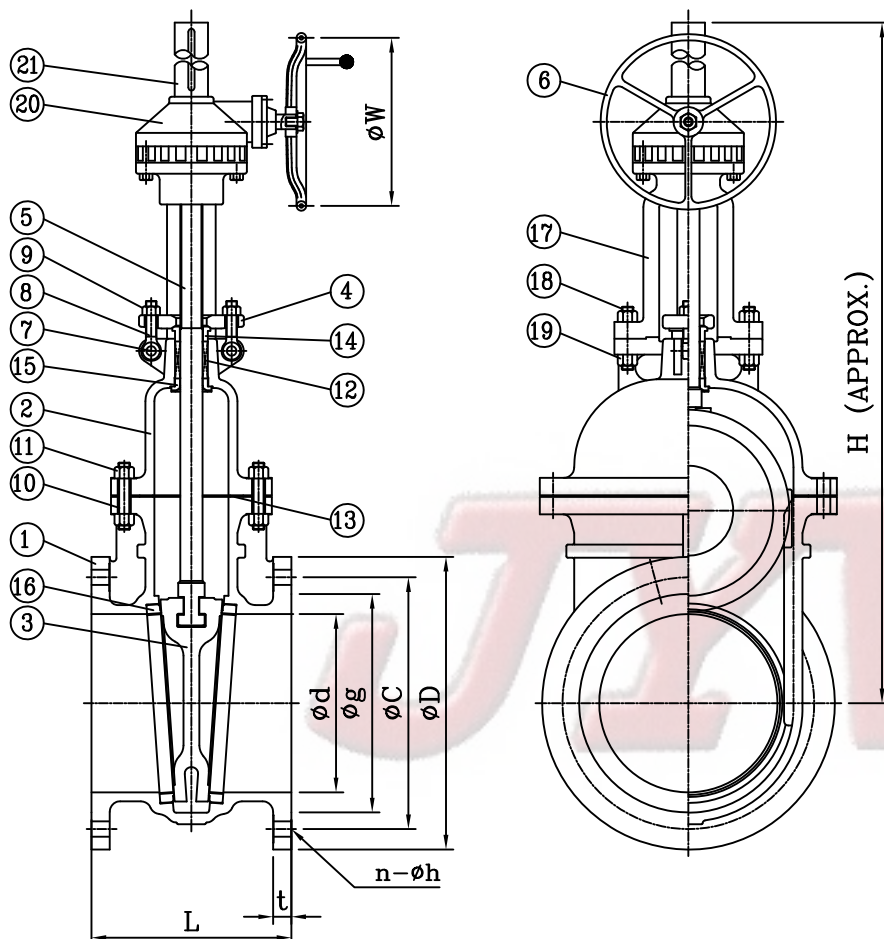

Bolted Bonnet Flexible seat
Rising Stem Flanged Ends

NO.	PARTS	MATERIAL
1	BODY	ASTM B148-C95800
2	BONNET	ASTM B148-C95800
3	DISC (FLEXIBLE)	ASTM B148-C95800
4	PACKING GLAND	BRONZE
5	STEM	ASTM B150-C63000
6	HANDWHEEL	STEEL
7	EYE BOLT PIN	STAINLESS STEEL
8	EYE BOLT	STAINLESS STEEL
9	NUT	STAINLESS STEEL
10	BONNET BOLT	STAINLESS STEEL
11	NUT	STAINLESS STEEL
12	PACKING	NON ASBESTOS
13	GASKET	NON ASBESTOS
14	PACKING GLAND RING	ASTM B150-C63000
15	BACK SEAT RING	ASTM B150-C63000
16	SEAT RING	INTERGRAL
17	BONNET YORK	ASTM B148-C95800
18	YORK BOLT	STAINLESS STEEL
19	NUT	STAINLESS STEEL
20	GEAR BOX	DUCTILE IRON
21	GEAR BOX COVER	STEEL

Test Pressure (Psi)

Rating	ANSI 150#
Size	20" AND 24"
Hydrostatic press test (Shell)	450
Hydrostatic press test (Seat)	325

Dimension Table

[Unit : mm]

SIZE (A)	BORE d	L	F L A N G E							W	H
			D	C	g		t	h	n		
20"	480	457	698	635	584		43	32	20	460	2270
24"	580	508	813	749.5	692		48	35	20	610	2670

1. HYDRO TEST : API598
2. FACE TO FACE : ANSI B16.10
3. FLANGE : ANSI B16.5

Remark : 1. The name plate shall be specified by purchaser as required.

✖ It's prohibited to copy or transcribe arbitrarily.

Cast Bronze ANSI Valves

■ Class 150 Hydrant Valves 30°

JYV Hydrant

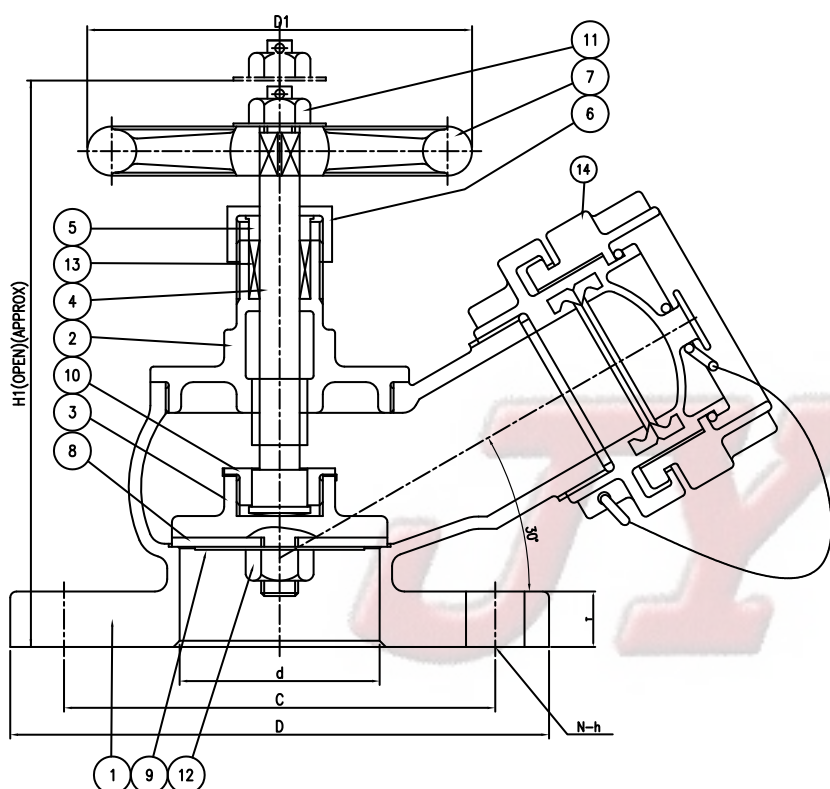

Bolted Bonnet Integral seat
Flanged Ends

NO.	PARTS	MATERIAL
1	BODY	BRONZE / ASTM B62
2	BONNET	BRONZE / ASTM B62
3	DISC	BRONZE / BRASS
4	STEM	BRASS
5	PACKING GLAND	BRASS
6	PACKING GLAND NUT	BRASS
7	HANDWHEEL	CAST IRON
8	DISC SEAT	TEFRON
9	DISC SEAT PLATE	STAINLESS STEEL
10	DISC NUT	BRASS
11	NUT	STAINLESS STEEL
12	NUT	BRASS
13	PACKING	NON ASBESTOS
14	COUPLING	BRONZE / BRASS

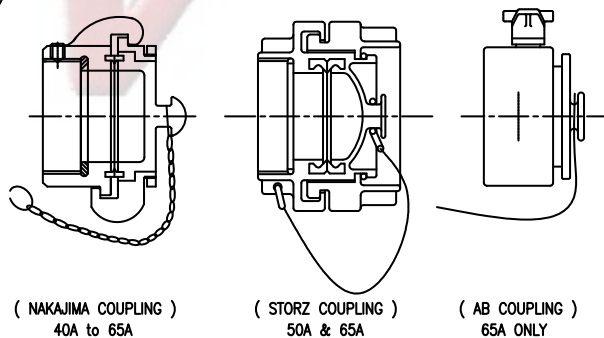

Test Pressure (Psi)

Rating	150#
Size	50A to 65A
Hydrostatic press test (Shell)	350
Hydrostatic press test (Seat)	225

Dimension Table (Unit : mm)

Rating	Size	d	H1	D1	FLANGE			
					D	C	t	n-h
150#	2	50	220	125	165	125	16	4-18
	2 1/2	65	245	140	185	145	16	4-18

Remark : 1. The name plate shall be specified by purchaser as required.

※ It's prohibited to copy or transcribe arbitrarily.



Cast Bronze ANSI Valves

■ Class 150 Hydrant Valves

Ref DIN86211

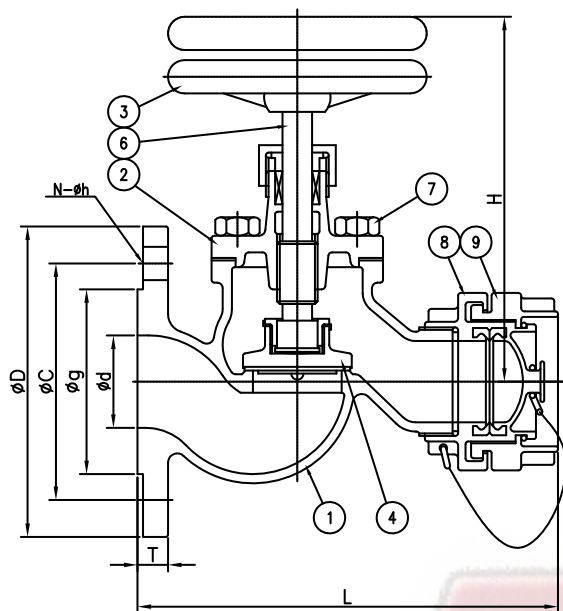

Bolted Bonnet Integral seat
Flanged Ends

NO.	PARTS	MATERIAL
1	BODY	BRONZE / ASTM B62
2	BONNET	BRONZE / ASTM B62
3	HANDWHEEL	CAST IRON
4	DISC	BRONZE
5	SEAT	INTEGRAL
6	STEM	BRASS / ASTM B124
7	BOLT	STAINLESS STEEL
8	COUPLING BODY	BRONZE
9	COUPLING DUST	BRONZE

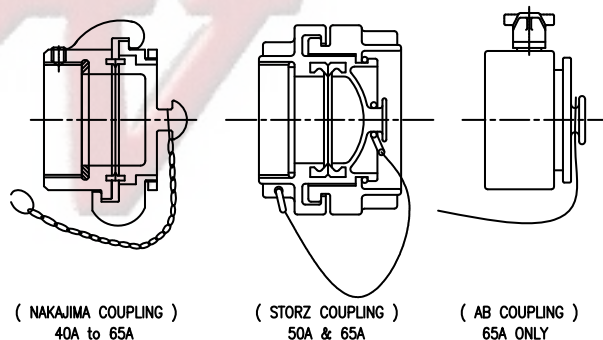
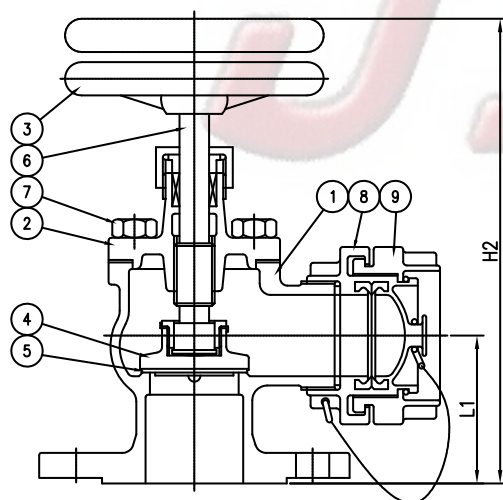

Test Pressure (Psi)

Rating	150#
Size	40A to 65A
Hydrostatic press test (Shell)	350
Hydrostatic press test (Seat)	225

Dimension Table

(Unit : mm)

Rating	Size	d	L	L1	H	H2	FLANGE				
							D	C	g	t	n-h
150#	1 1/2	40	165	75	170	165	127	98.4	73	16	4-18
	2	50	222	75	175	235	165	125	102	16	4-18
	2 1/2	65	260	90	205	265	185	145	122	16	4-18

Remark : 1. The name plate shall be specified by purchaser as required.

※ It's prohibited to copy or transcribe arbitrarily.

Cast Bronze ANSI Valves

■ CLASS 150 Gate Valves (Screw Bonnet) Non Rising Stem

MSS-SP-80

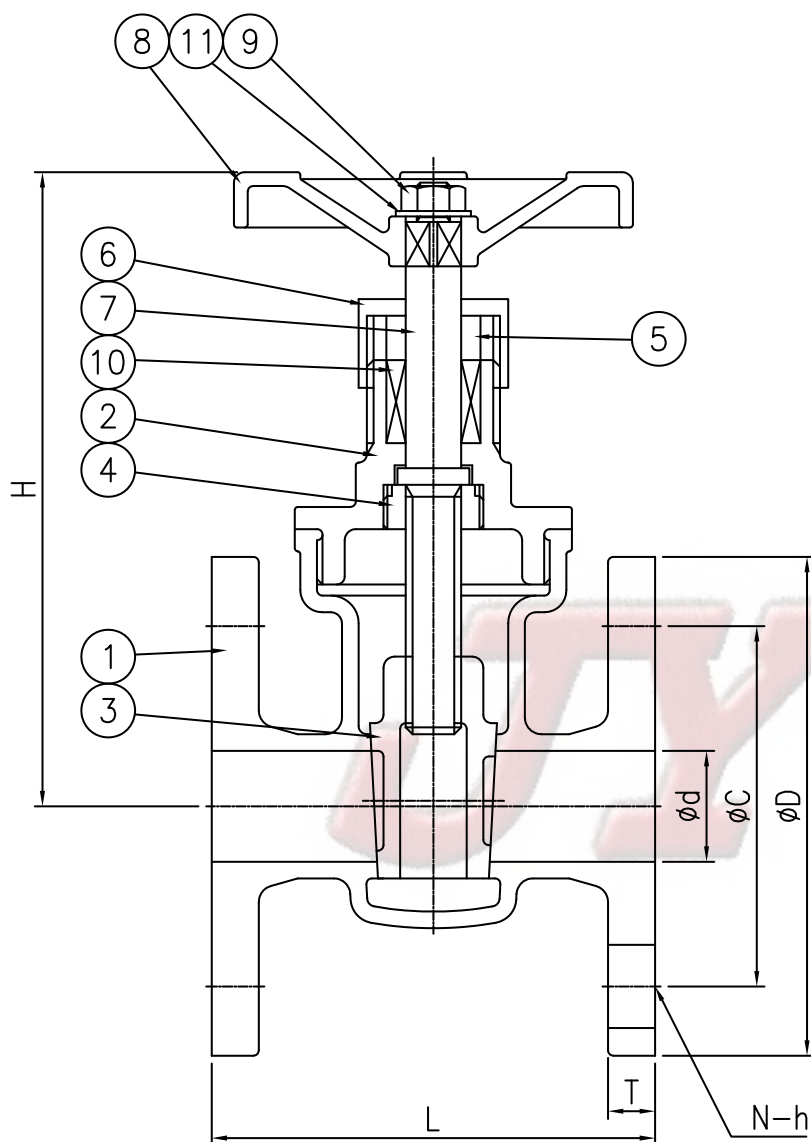

NO.	PARTS	MATERIAL
1	BODY	BRONZE
2	BONNET	BRONZE
3	DISC	BRONZE
4	RING	BRASS
5	PACKING GLAND	BRASS
6	GLAND NUT	BRASS
7	STEM	BRASS
8	HANDWHEEL	CAST IRON
9	HANDLE NUT	STEEL
10	PACKING	NON ASBESTOS
11	WASHER	STEEL

Test Pressure (Psi)

MSS-SP-80

Rating	150Psi
Hydrostatic press test (Shell)	350Psi
Hydrostatic press test (Seat)	225Psi

Dimension Table (Unit : mm)

Rating	Size	d	L	FLANGE				H
				D	C	N-h	T	
150LB (ANSI B16.5)	1/2	15	108	89	60.5	4-16	11.2	113
	3/4	20	117.3	99	70	4-16	12.7	117
	1	25	127	108	79.5	4-16	14.3	120
	1 1/4	32	165.1	117	89	4-16	15.9	135
	1 1/2	40	165.1	127	98.5	4-16	17.3	146
	2	50	177.8	152	120.5	4-19	17.3	179
	2 1/2	65	190.5	178	139.5	4-19	19.1	210
	3	80	203.2	190	152.5	8-19	20.7	242
	4	100	228.6	228	190.5	8-19	25.5	284

Flange face to face ; ANSI B16.10

※ It's prohibited to copy or transcribe arbitrarily.



Cast Bronze ANSI Valves

■ CLASS 150 Globe Valves (Screw Bonnet)

MSS-SP-80

■ CLASS 150 Globe Screw-Down Check Valves (Screw Bonnet)

MSS-SP-80

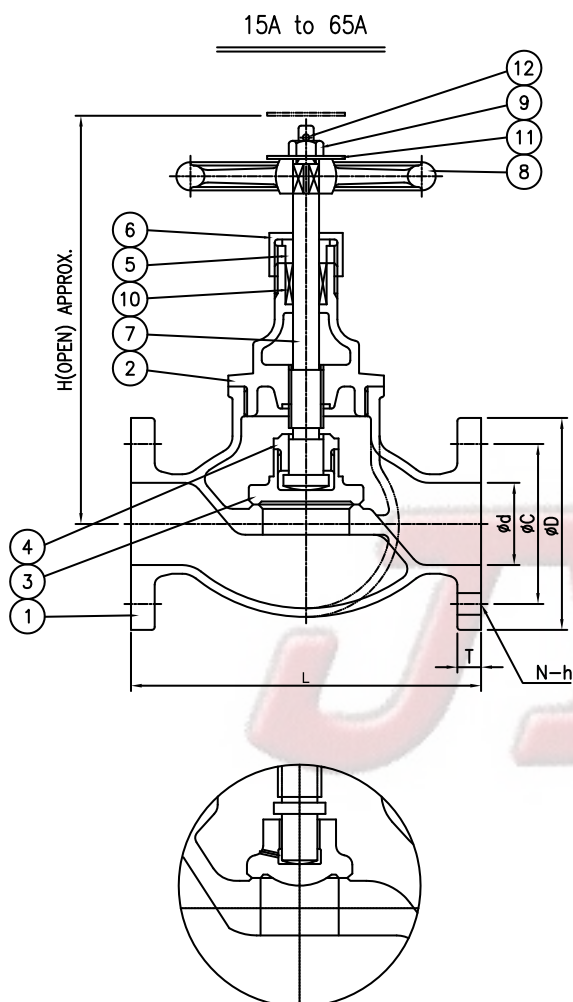

Screw Down Non Return
(SDNR)

NO.	PARTS	MATERIAL
1	BODY	BRONZE
2	BONNET	BRONZE / BRASS
3	DISC	BRONZE / BRASS
4	DISC NUT	BRONZE / BRASS
5	PACKING GLAND	BRONZE / BRASS
6	GLAND NUT	BRONZE / BRASS
7	STEM	BRASS
8	HANDWHEEL	CAST IRON
9	HANDLE NUT	STEEL
10	PACKING	NON ASBESTOS
11	WASHER	STEEL
12	SPLIT PIN	BRASS

Dimension Table (Unit : mm)

Rating	Size	d	L	FLANGE				H
				D	C	N-h	T	
150LB (ANSI B16.5)	1/2	15	108	89	60.5	4-16	11.2	76
	3/4	20	117.3	99	70	4-16	12.7	94
	1	25	127	108	79.5	4-16	14.3	110
	1 1/4	32	165.1	117	89	4-16	15.9	122
	1 1/2	40	165.1	127	98.5	4-16	17.3	122
	2	50	203.2	152	120.5	4-19	17.3	147
	2 1/2	65	215.9	178	139.5	4-19	19.1	166
	3	80	241.3	190	152.5	8-19	20.7	199
	4	100	292.1	228	190.5	8-19	25.5	220

Test Pressure (Psi)

MSS-SP-80

Rating	150Psi
Hydrostatic press test (Shell)	350Psi
Hydrostatic press test (Seat)	225Psi

Flange face to face ; ANSI B16.10

※ It's prohibited to copy or transcribe arbitrarily.

Cast Bronze ANSI Valves

■ CLASS 300 Globe Valves (Union Bonnet)

Ref JIS F7348

■ CLASS 300 Globe Screw-Down Check Valves (Union Bonnet)

Ref JIS F7413

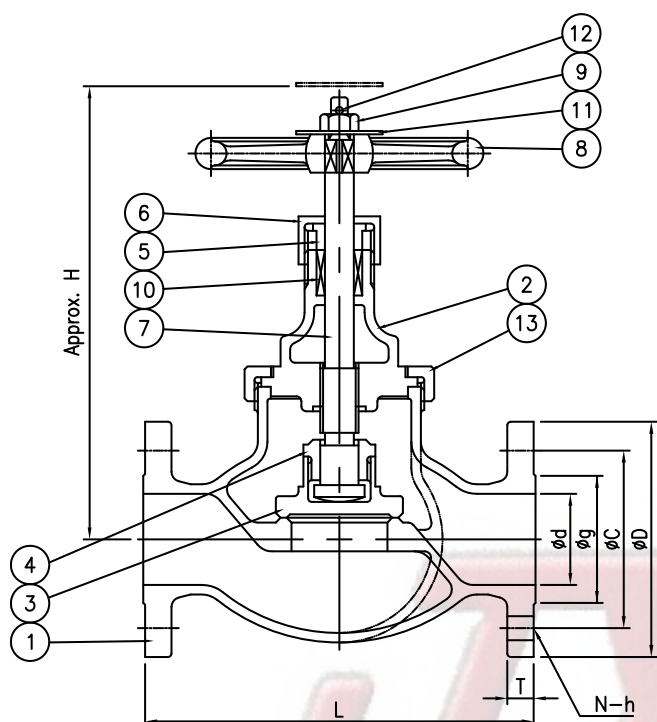

Union Bonnet Integral seat
Rising Stem Flanged Ends

NO.	PARTS	MATERIAL
1	BODY	BRONZE
2	BONNET	BRONZE / BRASS
3	DISC	BRASS
4	DISC NUT	BRASS
5	PACKING GLAND	BRASS
6	GLAND NUT	BRASS
7	STEM	BRASS
8	HANDWHEEL	CAST IRON
9	HANDLE NUT	STEEL
10	PACKING	NON ASBESTOS
11	WASHER	STEEL
12	SPLIT PIN	BRASS
13	BONNET NUT	BRONZE
14	INDICATOR PLATE	BRASS
15	INDICATOR PIECE	BRASS

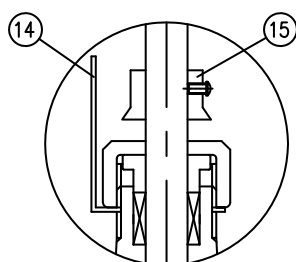

Indicator

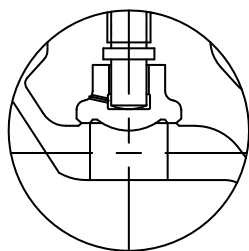

Screw Down Non Return
(SDNR)

Test Pressure (Psi)

Rating	ANSI 300#
Size	1/2" to 2"
Hydrostatic press test (Shell)	750
Hydrostatic press test (Seat)	500

Dimension Table

(Unit : mm)

Rating	Size	d	D	C	g	t	N-Øh	L	H
ANSI 300#	1/2"	15	95	66.5	35.1	14.3	4-16	110	155
	3/4"	20	117	82.6	42.9	15.9	4-19	120	165
	1"	25	124	88.9	50.8	17.5	4-19	130	185
	1 1/4"	32	133	98.6	63.5	19.1	4-19	160	195
	1 1/2"	40	155	114.3	73.2	20.7	4-22	180	210
	2"	50	165	127	91.9	22.3	8-19	180	210

Remark : 1. The name plate shall be specified by purchaser as required.

✖ It's prohibited to copy or transcribe arbitrarily.



Cast Bronze ANSI Valves

■ CLASS 150 Globe Valves (Union Bonnet)

Ref JIS F7348

■ CLASS 150 Globe Screw-Down Check Valves (Union Bonnet)

Ref JIS F7413

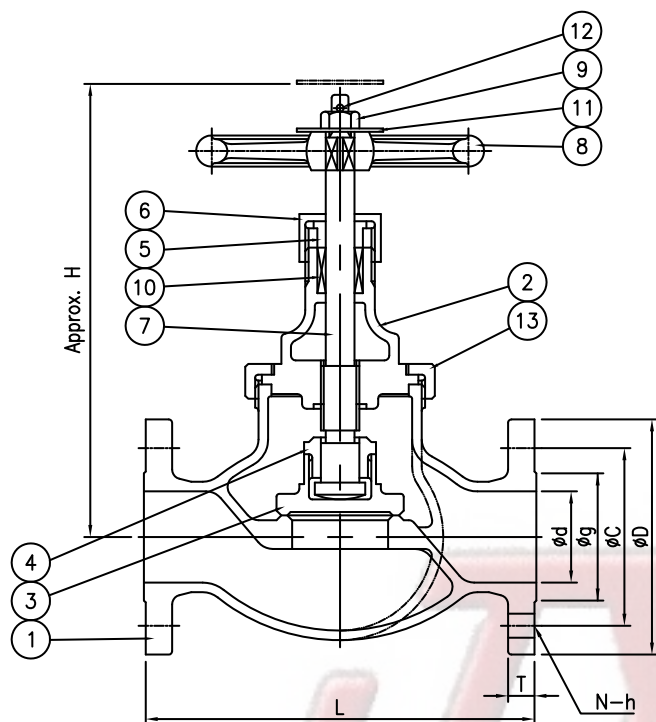

Union Bonnet Integral seat
Rising Stem Flanged Ends

NO.	PARTS	MATERIAL
1	BODY	BRONZE / ASTM B62
2	BONNET	BRONZE / ASTM B62
3	DISC	BRASS
4	DISC NUT	BRASS
5	PACKING GLAND	BRASS
6	GLAND NUT	BRASS
7	STEM	BRASS
8	HANDWHEEL	CAST IRON
9	HANDLE NUT	STEEL
10	PACKING	NON ASBESTOS
11	WASHER	STEEL
12	SPLIT PIN	BRASS
13	BONNET NUT	BRONZE
14	INDICATOR PLATE	BRASS
15	INDICATOR PIECE	BRASS

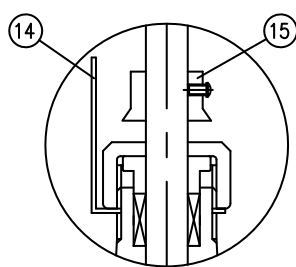

Indicator

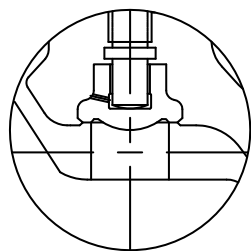

Screw Down Non Return
(SDNR)

Test Pressure (Psi)

Rating	ANSI 150#
Size	1/2" to 2"
Hydrostatic press test (Shell)	350
Hydrostatic press test (Seat)	225

Dimension Table

(Unit : mm)

Rating	Size	d	D	C	g	t	N-øh	L	H
ANSI 300#	1/2"	15	89	60.5	35.1	12	4-16	110	130
	3/4"	20	98	70	42.9	14	4-16	120	140
	1"	25	108	79.5	50.8	14	4-16	130	160
	1 1/4"	32	118	89	63.5	16	4-16	160	170
	1 1/2"	40	127	98.6	73.2	16	4-16	180	190
	2"	50	152	120.5	91.9	16	4-19	180	210

Remark : 1. The name plate shall be specified by purchaser as required.

※ It's prohibited to copy or transcribe arbitrarily.

Cast Bronze ANSI Valves

■ CLASS 150 Gate Valves (Union Bonnet)

Ref JIS F7368

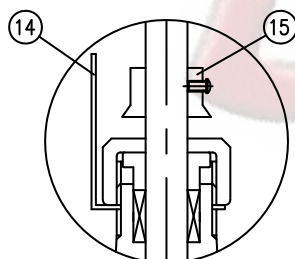
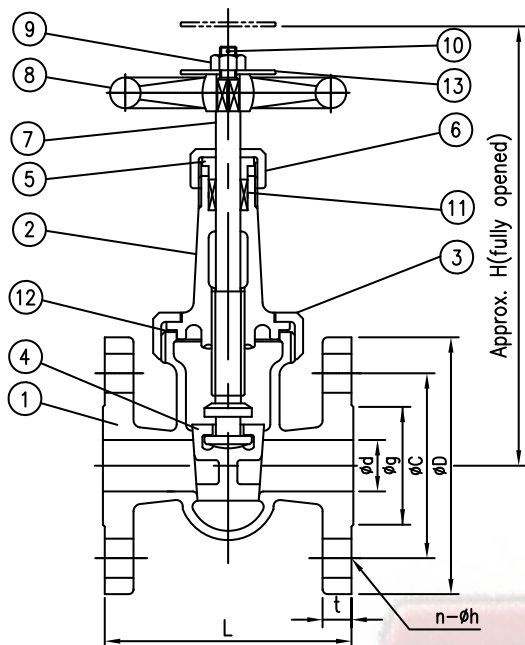

Indicator

Union Bonnet Integral seat
Rising Stem Flanged Ends

NO.	PARTS	MATERIAL
1	BODY	BRONZE / ASTM B62
2	BONNET	BRONZE / ASTM B62
3	BONNET NUT	BRONZE / ASTM B62
4	DISC	BRONZE / ASTM B62
5	PACKING GLAND	BRASS
6	PACKING GLAND NUT	BRASS
7	STEM	BRASS
8	HANDWHEEL	CAST IRON
9	HEXAGON NUT	STAINLESS STEEL
10	SPLIT PIN	BRASS
11	PACKING	NON ASBESTOS
12	GASKET	NON ASBESTOS
13	WASHER	STAINLESS STEEL
14	INDICATOR PLATE	BRASS
15	INDICATOR PIECE	BRASS

Test Pressure (Psi)

Rating	ANSI 150#
Size	1/2" to 2"
Hydrostatic press test (Shell)	350
Hydrostatic press test (Seat)	225

Dimension Table (Unit : mm)

Rating	Size	d	D	C	g	t	N-øh	L	H
ANSI 150#	1/2"	15	89	60.5	35.1	12	4-16	100	175
	3/4"	20	99	70	42.9	14	4-16	110	200
	1"	25	108	79.5	50.8	14	4-16	120	220
	1 1/4"	32	117	89	63.5	16	4-16	140	250
	1 1/2"	40	127	98.6	73.2	16	4-16	150	290
	2	50	152	120.5	91.9	16	4-19	160	310

Remark : 1. The name plate shall be specified by purchaser as required.

✖ It's prohibited to copy or transcribe arbitrarily.



Cast Bronze ANSI Valves

■ CLASS 300 Gate Valves (Union Bonnet)

Ref JIS F7368

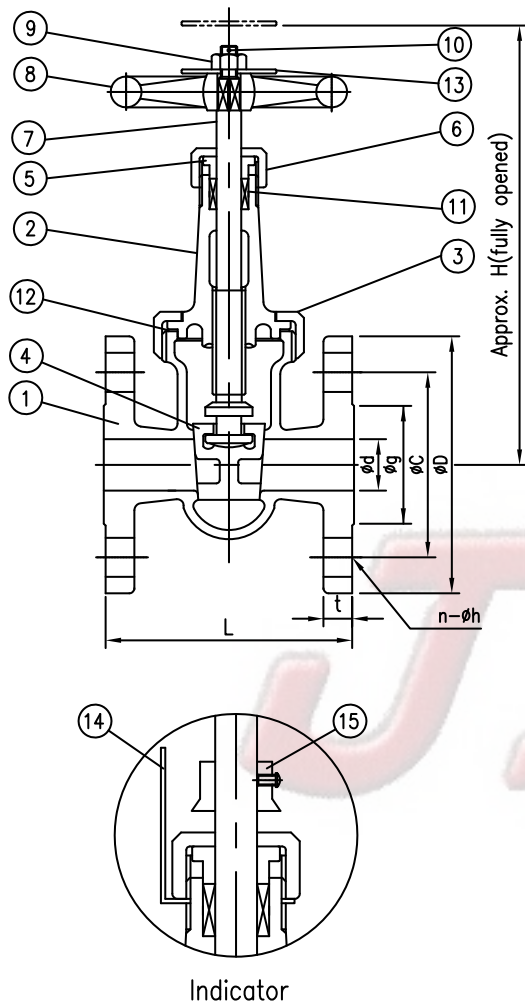

Union Bonnet Integral seat
Rising Stem Flanged Ends

NO.	PARTS	MATERIAL
1	BODY	BRONZE / ASTM B62
2	BONNET	BRONZE / ASTM B62
3	BONNET NUT	BRONZE / ASTM B62
4	DISC	BRONZE / ASTM B62
5	PACKING GLAND	BRASS
6	PACKING GLAND NUT	BRASS
7	STEM	BRASS
8	HANDWHEEL	CAST IRON
9	HEXAGON NUT	STAINLESS STEEL
10	SPLIT PIN	BRASS
11	PACKING	NON ASBESTOS
12	GASKET	NON ASBESTOS
13	WASHER	STAINLESS STEEL
14	INDICATOR PLATE	BRASS
15	INDICATOR PIECE	BRASS

Test Pressure (Psi)

Rating	ANSI 300#
Size	1/2" to 2"
Hydrostatic press test (Shell)	750
Hydrostatic press test (Seat)	500

Dimension Table (Unit : mm)

Rating	Size	d	D	C	g	t	N-øh	L	H
ANSI 300#	1/2"	15	95	66.5	35.1	14.3	4-16	100	175
	3/4"	20	117	82.6	42.9	15.9	4-19	115	200
	1"	25	124	88.9	50.8	17.5	4-19	125	220
	1 1/4"	32	133	98.6	63.5	19.1	4-19	145	250
	1 1/2"	40	156	114.3	73.2	20.7	4-22	160	290
	2"	50	165	127	91.9	22.3	8-19	170	310

Remark : 1. The name plate shall be specified by purchaser as required.

※ It's prohibited to copy or transcribe arbitrarily.

Cast Bronze ANSI Valves

■ CLASS 150 Swing Check Valves (Screw Bonnet)

Ref JIS F7371

■ CLASS 150 Swing Check Valves (Bolted Bonnet)

Ref JIS F7373

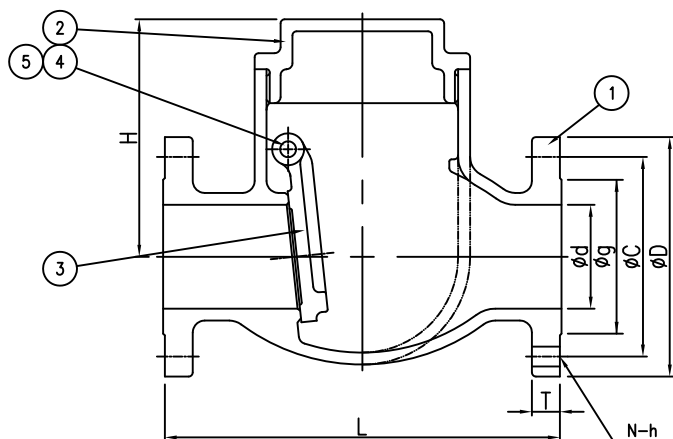

Screw Bonnet Integral seat
Swing type & Disc Flanged Ends

NO.	PARTS	MATERIAL
1	BODY	BRONZE / ASTM B62
2	BONNET	BRONZE / ASTM B62
3	DISC	BRONZE / ASTM B62
4	HINGE PIN	BRASS
5	PLUG	BRASS / STAINLESS STEEL
6	GASKET	NON ASBESTOS
7	BOLT	STAINLESS STEEL
8	NUT	STAINLESS STEEL

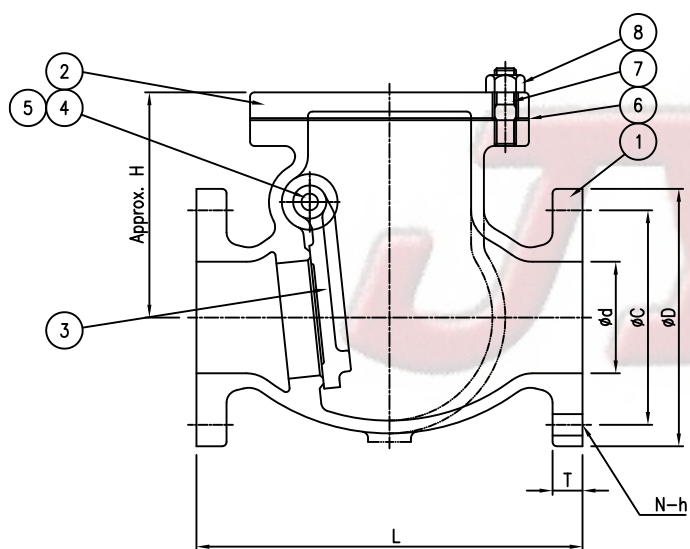

Test Pressure (Psi)

Rating	ANSI 150#
Size	1/2" to 5"
Hydrostatic press test (Shell)	350
Hydrostatic press test (Seat)	225

1. face to face ; according to JIS F7371,F7373

Dimension Table (Unit : mm)

Rating	Size	d	D	C	g	t	N-øh	L	H
ANSI 150#(SB)	1/2"	25	89	60.5	35.1	12	4-16	110	69
	3/4"	25	99	70	42.9	14	4-16	110	69
	1"	25	108	79.5	50.8	14	4-16	110	69
	1 1/4"	32	117	89	63.5	16	4-16	130	79
	1 1/2"	40	127	98.6	73.2	16	4-16	140	93
ANSI 150#(BB)	2"	50	152	120.5	91.9	16	4-19	210	109
	2 1/2"	65	178	139.7	104.6	18	4-19	240	126
	3"	80	190	152.4	127	18	4-19	270	136
	4"	100	228	190.5	157.2	18	8-19	300	153
	5"	125	254	215.9	185.7	24	8-23	350	180

Remark : 1. The name plate shall be specified by purchaser as required.

✖ It's prohibited to copy or transcribe arbitrarily.



Cast Bronze ANSI Valves

■ CLASS 150 Lift Check Valves (Union Bonnet)

Ref JIS F7417

■ CLASS 150 Lift Check Valves (Bolted Bonnet)

Ref JIS F7358

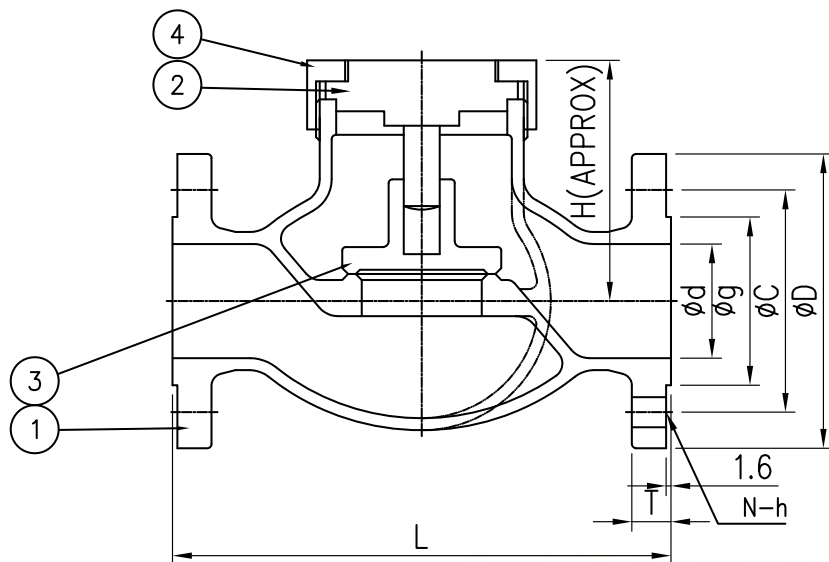

Screw Bonnet Integral seat
Lift type Disc Flanged Ends

NO.	PARTS	MATERIAL
1	BODY	BRONZE / ASTM B62
2	BONNET	BRASS
3	DISC	BRONZE / ASTM B62
4	UNION NUT	BRONZE
5	BOLT	STAINLESS STEEL
5	NUT	STAINLESS STEEL

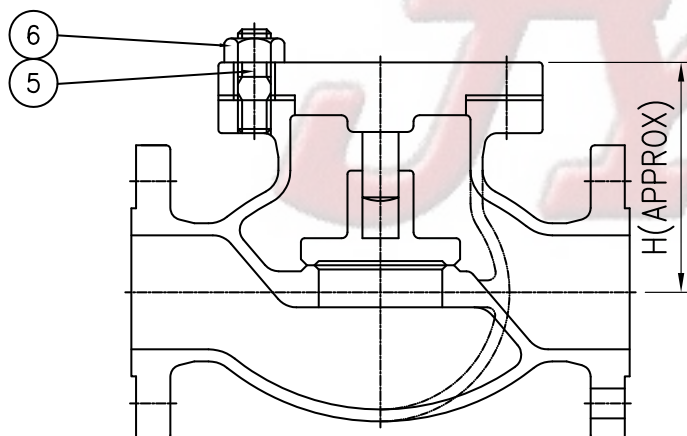

Dimension Table (Unit : mm)

Rating	Size	d	D	C	g	T	N-øh	L	H
ANSI 150#(UB)	1/2"	15	89	60.5	35.1	12	4-16	110	57
	3/4"	20	99	70	42.9	14	4-16	120	63
	1"	25	108	79.5	50.8	14	4-16	130	69
	1 1/4"	32	117	89	63.5	16	4-16	160	73
	1 1/2"	40	127	98.6	73.2	16	4-16	180	81
ANSI 150#(BB)	2"	50	152	120.5	91.9	16	4-19	220	100
	2 1/2"	65	178	139.7	104.6	18	4-19	270	115
	3"	80	190	152.4	127	18	4-19	300	125
	4"	100	228	190.5	157.2	18	8-19	350	125
	5"	125	254	215.9	185.7	24	8-23	420	160

Test Pressure (Psi)

Rating	ANSI 150#
Size	1/2" to 5"
Hydrostatic press test (Shell)	350
Hydrostatic press test (Seat)	225

1. face to face ; according to JIS F7417,F7359

Remark : 1. The name plate shall be specified by purchaser as required.

✖ It's prohibited to copy or transcribe arbitrarily.

Cast Bronze ANSI Valves

■ CLASS 150 Gate Valves (Bolted Bonnet) Non Rising Stem

Ref JIS F7364

Bolted Bonnet Renewable seat
Non Rising Stem Flanged Ends

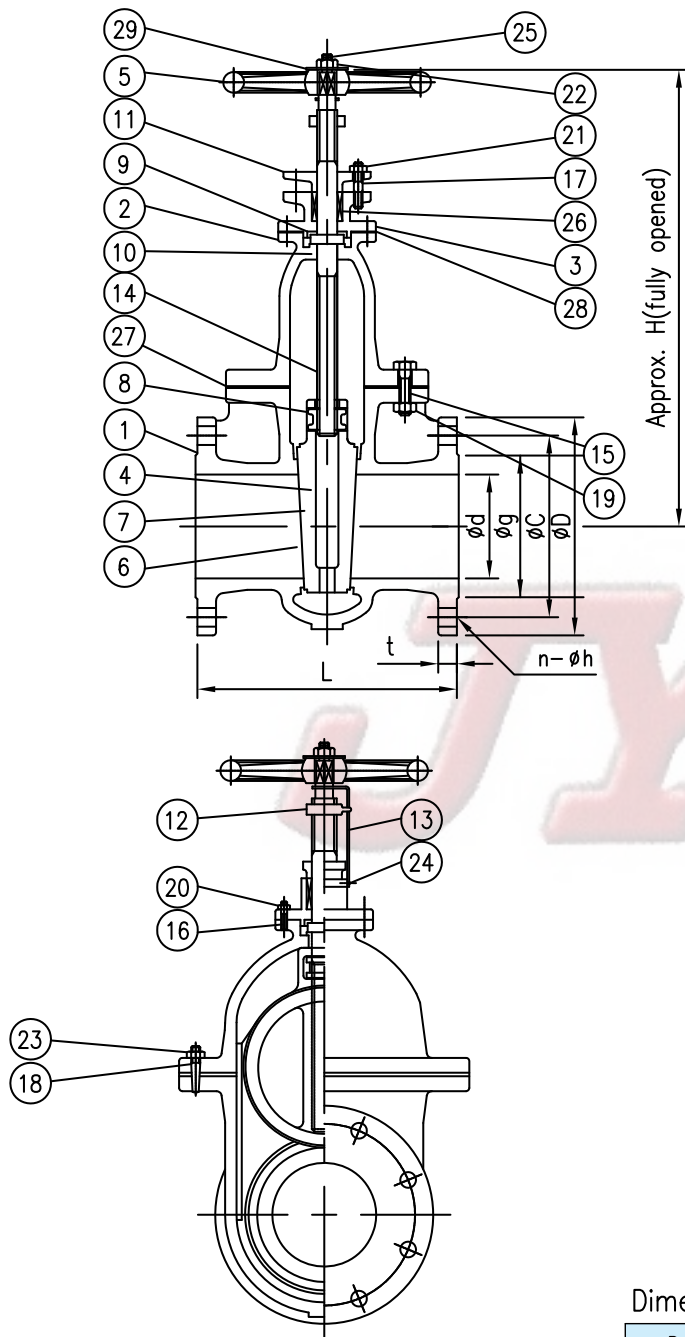

NO.	PARTS	MATERIAL
1	BODY	BRONZE / ASTM B62
2	BONNET	BRONZE / ASTM B62
3	STUFFING BOX	BRONZE / ASTM B62
4	DISC	BRONZE / ASTM B62
5	HANDWHEEL	CAST IRON
6	VALVE SEAT OF BODY	INTEGRAL / BRONZE
7	VALVE SEAT OF DISC	INTEGRAL / BRONZE
8	SCREWED PIECE	BRASS
9	GUIDE BUSH	INTEGRAL
10	GUIDE BUSH	INTEGRAL
11	PACKING GLAND	BRONZE
12	INDICATOR	BRASS
13	INDICATOR PLATE	BRASS
14	STEM	BRASS / ASTM B124
15	STUD BOLT	STAINLESS STEEL / BRASS
16	STUD BOLT	STAINLESS STEEL / BRASS
17	STUD BOLT	STAINLESS STEEL / BRASS
18	TAPER PIN WITH THREAD	STAINLESS STEEL
19	HEXAGON NUT	STAINLESS STEEL
20	HEXAGON NUT	STAINLESS STEEL
21	HEXAGON NUT	STAINLESS STEEL
22	HEXAGON NUT	STAINLESS STEEL
23	HEXAGON NUT	STAINLESS STEEL
24	MACHINE SCREW	BRASS
25	SPLIT PIN	BRASS
26	PACKING	NON ASBESTOS
27	GASKET	NON ASBESTOS
28	GASKET	NON ASBESTOS
29	WASHER	STEEL

Test Pressure (Psi)

Rating	ANSI 150#
Size	2" to 16"
Hydrostatic press test (Shell)	350
Hydrostatic press test (Seat)	225

Dimension Table

(Unit : mm)

Rating	Size	2"	2 1/2"	3"	4"	5"	6"	8"	10"	12"	14"	16"
ANSI 150#	d	50	65	80	100	125	150	200	250	300	335	380
	D	152	178	191	229	254	279	343	406	483	533	597
	C	120.7	139.7	152.4	190.5	215.9	241.3	298.5	362	431.8	476.3	539.8
	g	91.9	104.6	127	157.2	185.7	215.9	269.7	323.9	381	412.8	469.9
	t	16	18	20	22	24	26	28	28	30	30	32
	N-øh	4-19	4-19	4-19	8-19	8-23	8-23	8-23	12-26	12-26	12-29	16-29
	L	200	220	230	250	270	290	320	380	440	500	590
	H	300	350	400	450	520	580	700	840	960	1050	1150

Remark : 1. The name plate shall be specified by purchaser as required.

✖ It's prohibited to copy or transcribe arbitrarily.